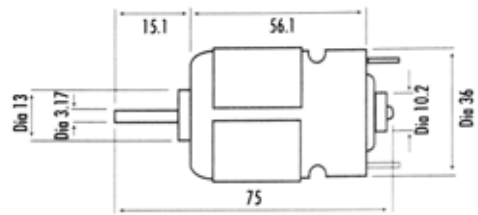
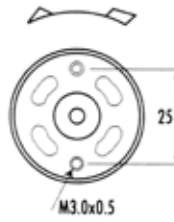
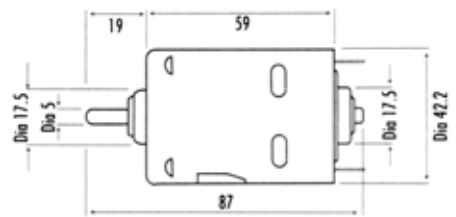
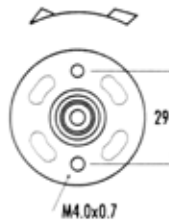
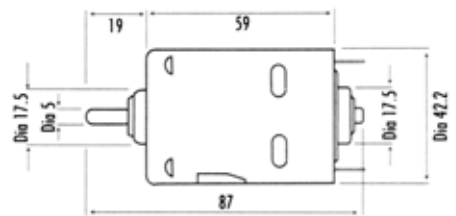
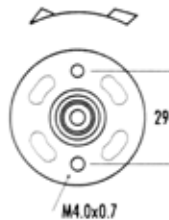
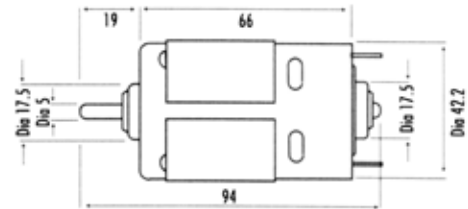
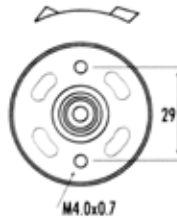

High Power DC Motors

M00070

M00072

M00074

M00076

Specifications	M00070	M00072	M00074	M00076
Voltage	12V	6V	12V	12V
Speed	11,800 RPM	20,000 RPM	18,800 RPM	9,700 RPM
Current	0.8A	4.0A	2.6A	1.3A
Operating Voltage	6 - 12V	3 - 6V	6 - 12V	6 - 18V
At Stall				
Torque	2.7 Kg/CM	1.91 Kg/CM	4.9 Kg/CM	6.0 Kg/CM
Current	26A	67A	92A	57A
At Maximum Efficiency				
Efficiency	76%	57%	71%	73%
Power	43W	45W	107W	52W
Speed	9,800 RPM	13,730 RPM	15,520 RPM	8,490 RPM
Torque	0.42 Kg/CM	0.32 Kg/CM	0.67 Kg/CM	0.60 Kg/CM
Current	4.7A	13.5A	12.8A	6.0A